

# Always here to help you

Register your product and get support at  
[www.philips.com/welcome](http://www.philips.com/welcome)



series S7000



# PHILIPS

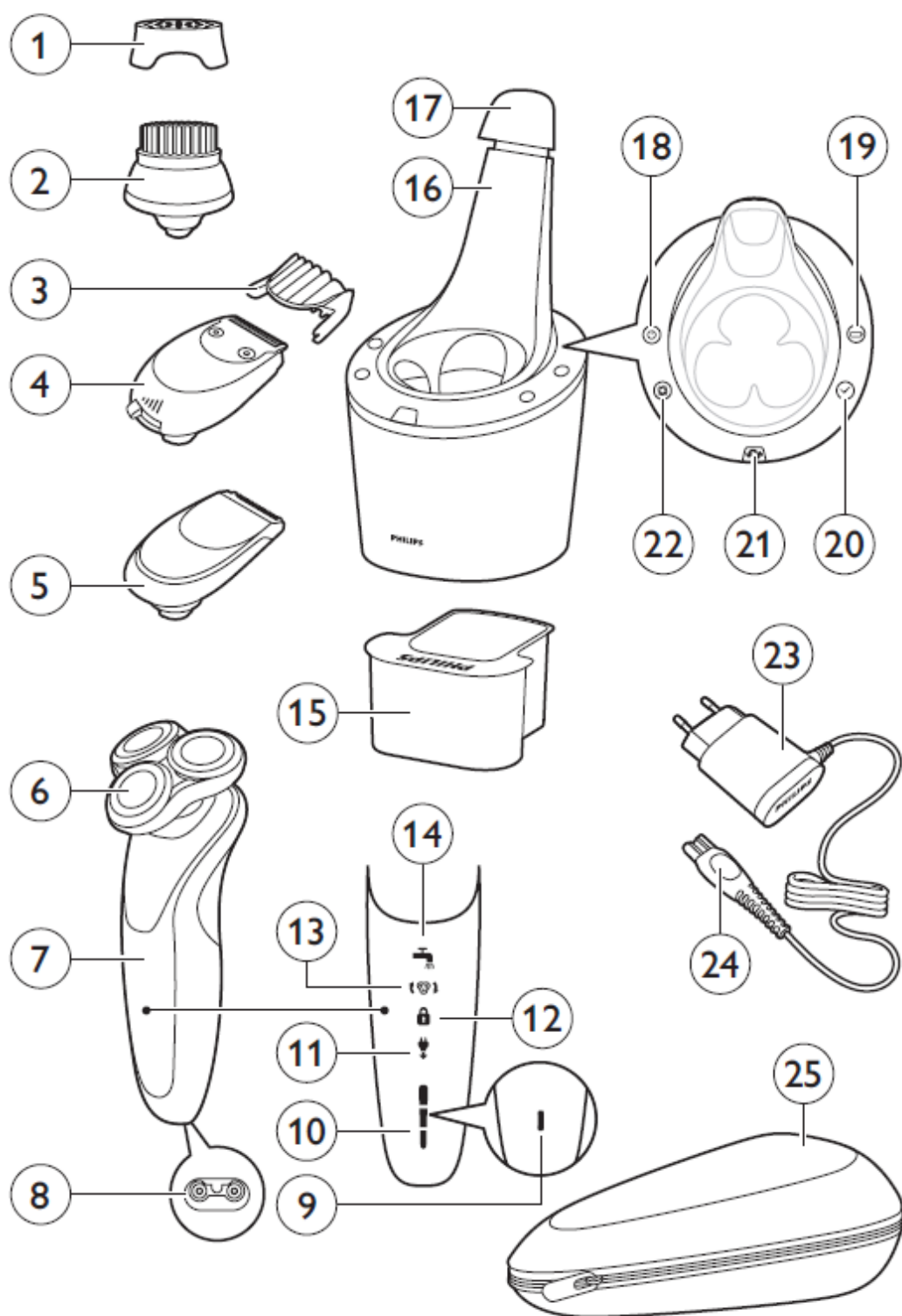

### Introduction

Congratulations on your purchase and welcome to Philips! To fully benefit from the support that Philips offers, register your product at [www.philips.com/welcome](http://www.philips.com/welcome).

### General description (Fig. 1)

- 1 Protection cap for cleansing brush attachment (specific types only)
- 2 Click-on cleansing brush attachment (specific types only)
- 3 Comb for beard styler attachment (specific types only)
- 4 Click-on beard styler attachment (specific types only)
- 5 Click-on trimmer attachment (specific types only)
- 6 Click-on shaving unit
- 7 Handle
- 8 Socket for small plug
- 9 Battery charge indicator 1 light
- 10 Battery charge indicator 3 lights
- 11 'Unplug for use' symbol
- 12 Travel lock symbol
- 13 Replacement reminder
- 14 Cleaning reminder
- 15 Cleaning cartridge for SmartClean system
- 16 SmartClean system (specific types only)
- 17 Cap of SmartClean system
- 18 On/off button
- 19 Battery symbol
- 20 Ready symbol
- 21 Replacement symbol
- 22 Cleaning symbol
- 23 Adapter

24 Small plug

25 Pouch

*Note: The accessories supplied may vary for different products. The box shows the accessories that have been supplied with your appliance.*

### Important safety information

Read this important information carefully before you use the appliance and its accessories and save it for future reference. The accessories supplied may vary for different products.

#### **Danger**

- Keep the adapter dry.

#### **Warning**

- The adapter contains a transformer.  
Do not cut off the adapter to replace it with another plug, as this causes a hazardous situation.
- This appliance can be used by children aged from 8 years and above and persons with reduced physical, sensory or mental capabilities or lack of experience and knowledge if they have been given supervision or instruction concerning use of the appliance in a safe way and understand the hazards involved. Children shall not play with the appliance. Cleaning and user maintenance shall not be made by children without supervision.
- Always unplug the shaver before you clean it under the tap.
- Always check the appliance before you use it.  
Do not use the appliance if it is damaged, as this may cause injury. Always replace a damaged part with one of the original type.



## 6 ENGLISH



### Caution

- Never immerse the cleaning system or the charging stand in water and do not rinse it under the tap.
- Never use water hotter than 80°C to rinse the shaver.
- Only use this appliance for its intended purpose as shown in the user manual.
- For hygienic reasons, the appliance should only be used by one person.
- Never use compressed air, scouring pads, abrasive cleaning agents or aggressive liquids such as petrol or acetone to clean the appliance.
- If your shaver comes with a cleaning system, always use the original Philips cleaning fluid (cartridge or bottle, depending on the type of cleaning system).
- Always place the cleaning system on a stable, level and horizontal surface to prevent leakage.
- If your cleaning system uses a cleaning cartridge, always make sure that the cartridge compartment is closed before you use the cleaning system to clean or charge the shaver.
- When the cleaning system is ready for use, do not move it to prevent leakage of cleaning fluid.
- Do not use the adapter in or near wall sockets that contain or have contained an electric air freshener to prevent irreparable damage to the adapter.
- Water may drip from the socket at the bottom of the shaver when you rinse it. This is normal and not dangerous because all electronics are enclosed in a sealed power unit inside the shaver.



### Electromagnetic fields (EMF)

- This Philips appliance complies with all applicable standards and regulations regarding exposure to electromagnetic fields.

### General

- This shaver is waterproof. It is suitable for use in the bath or shower and for cleaning under the tap. For safety reasons, the shaver can therefore only be used without cord.
- The appliance is suitable for mains voltages ranging from 100 to 240 volts.
- The adapter transforms 100-240 volts to a safe low voltage of less than 24 volts.
- Maximum noise level:  $L_c = 69\text{dB(A)}$

## The display

### Charging

#### Battery charge indicator with 3 lights

- Charging takes approx. 1 hour.
- Quick charge: When the appliance is connected to the mains, the lights of the battery charge indicator light up one after the other continuously. When the appliance contains enough energy for one shave, the bottom light of the battery charge indicator starts flashing slowly.
- If you leave the appliance connected to the mains, the charging process continues. To indicate that the appliance is charging, first the bottom light flashes and then lights up continuously. Then the second light flashes and then lights up continuously, and so on until the appliance is fully charged.

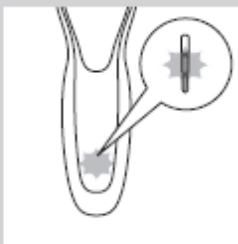



### Battery charge indicator with 1 light

- Charging takes approx. 1 hour:
- Quick charge: When the appliance does not contain enough energy for one shave, the battery charge indicator flashes fast. When the battery charge indicator starts to flash slowly, the appliance contains enough energy for one shave.
- If you leave the appliance connected to the mains, the charging process continues. To indicate that the appliance is charging, the battery charge indicator flashes slowly.

### Battery fully charged

---

*Note: This appliance can only be used without a cord.*

*Note: When the battery is full, the display switches off automatically after 30 minutes. If you press the on/off button during charging, the 'unplug for use' symbol flashes white to remind you that you have to disconnect the appliance from the mains.*



When the battery is fully charged, all lights of the battery charge indicator light up continuously.

- Battery charge indicator with 3 lights
- Battery charge indicator with 1 light



### Battery low

---

When the battery is almost empty, the bottom light flashes orange.



- Battery charge indicator with 3 lights



- Battery charge indicator with 1 light

### Remaining battery capacity

---



#### **Battery charge indicator with 3 lights**

- The remaining battery capacity is indicated by the lights of the battery charge indicator that light up continuously.

### 'Unplug for use' reminder

---

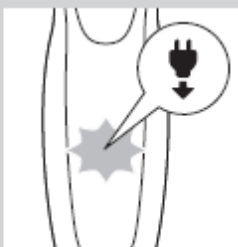

- The appliance is equipped with an 'unplug for use' reminder. The 'unplug for use' starts to flash to remind you that you have to disconnect the appliance from the adapter before you can switch it on.



### Cleaning reminder



For optimal shaving performance, we advise you to clean the shaver after every use.

- When you switch off the shaver, the cleaning reminder flashes to remind you to clean the shaver.

### Travel lock

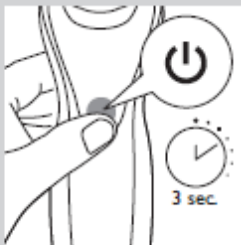

You can lock the shaver when you are going to travel. The travel lock prevents the shaver from being switched on by accident.

#### Activating the travel lock

- 1** Press the on/off button for 3 seconds to enter the travel lock mode.



- While you activate the travel lock, the travel lock symbol lights up continuously. When the travel lock is activated, the travel lock symbol flashes.

#### Deactivating the travel lock



- 1** Press the on/off button for 3 seconds.
- The travel lock symbol flashes and then lights up continuously.  
The shaver is now ready for use again.

## Replacing shaving heads



For maximum shaving performance, we advise you to replace the shaving heads every two years.

- The appliance is equipped with a replacement reminder which reminds you to replace the shaving heads. The replacement reminder lights up continuously.

*Note: After replacing the shaving heads, you need to reset the replacement reminder by pressing the on/off button for 7 seconds.*

## Charging

Charging takes approx. 1 hour.

*Note: This appliance can only be used without cord.*

Charge the shaver before you use it for the first time and when the display indicates that the battery is almost empty.

## Charging with the adapter



- 1** Insert the small plug into the appliance and put the adapter in the wall socket.

## Charging in the SmartClean system (specific types only)

- 1** Put the small plug in the SmartClean system.
- 2** Put the adapter in the wall socket.

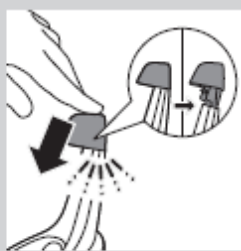

- 3** Press down the top cap to be able to place the shaver in the holder ('click').

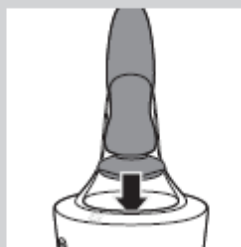

- 4** Hold the shaver upside down above the holder. Make sure the front of the shaver points towards the SmartClean system.

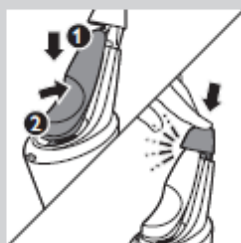

- 5** Place the shaver in the holder, tilt the shaver backwards and press down the top cap to connect the shaver ('click').
- The battery symbol flashes slowly to indicate the shaver is charging.

## Using the shaver

### Switching the appliance on and off



- 1** To switch on the appliance, press the on/off button once.
- 2** To switch off the appliance, press the on/off button once.
- Battery charge indicator with 3 lights: The display lights up for a few seconds to show the remaining battery status.

## Shaving



### Skin adaptation period

Your first shaves may not bring you the result you expect and your skin may even become slightly irritated. This is normal. Your skin and beard need time to adapt to any new shaving system. We advise you to shave regularly (at least 3 times a week) with this shaver for a period of 3 weeks to allow your skin to adapt to the new shaver.

*Note: This appliance can only be used without cord.*

- 1** Switch on the appliance.
- 2** Move the shaving heads over your skin in circular movements.

*Note: Do not make straight movements.*



- 3** Clean the shaver after use (see chapter 'Cleaning and maintenance').

### Wet shaving

You can also use this shaver in the shower or on a wet face with shaving foam or shaving gel. To shave with shaving foam or shaving gel, follow the steps below:



- 1** Apply some water to your skin.
- 2** Apply shaving foam or shaving gel to your skin.



- 3** Rinse the shaving unit under the tap to ensure that the shaving unit glides smoothly over your skin.
- 4** Switch on the appliance.



- 5** Move the shaving heads over your skin in circular movements.

*Note: Rinse the shaver under the tap regularly to ensure that it continues to glide smoothly over your skin.*

- 6** Dry your face and thoroughly clean the shaver after use (see chapter 'Cleaning and maintenance').

*Note: Make sure you rinse all foam or shaving gel off the shaver.*

### Using the click-on attachments

---

*Note: The accessories supplied may vary for different products. The box shows the accessories that have been supplied with your appliance.*

### Removing or attaching the click-on attachments

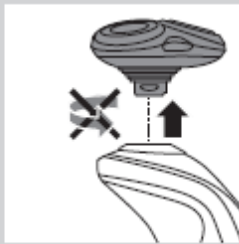

- 1** Make sure that the appliance is switched off.
- 2** Pull the attachment straight off the appliance.

*Note: Do not twist the attachment while you pull it off the appliance.*



- 3** Insert the lug of the attachment into the slot in the top of the appliance. Then press down the attachment to attach it to the appliance ('click').

### Using the trimmer attachment

You can use the trimmer attachment to groom your sideburns and moustache.



- 1** Make sure the appliance is switched off.
- 2** Insert the lug of the trimmer attachment into the slot in the top of the appliance. Then press down the trimmer attachment to attach it to the appliance ('click').

- 3** Switch on the appliance.



- 4** You can now start trimming.

- 5** Clean the attachment after use (see chapter 'Cleaning and maintenance').

### Using the beard styler attachment



- 1** Make sure the appliance is switched off.
- 2** Insert the lug of the attachment into the slot in the top of the appliance. Then press down the attachment to attach it to the appliance ('click').

### Using the beard styler attachment with comb

You can use the beard styler attachment with the comb attached to style your beard at one fixed setting, but also at different length settings. You can use it also to pre-trim any long hairs before shaving to have a more comfortable shave.

The hair length settings on the beard styler attachment correspond to the remaining hair length after cutting and range from 1 to 5mm.



- 1** Slide the comb straight into the guiding grooves on both sides of the attachment ('click').



- 2** Press the length selector and then push it to the left or right to select the desired hair length setting.
- 3** Switch on the appliance.

- 4** You can now start styling your beard by moving the attachment upwards with gentle pressure making sure the front of the comb is in full contact with the skin.
- 5** Clean the attachment after use (see chapter 'Cleaning and maintenance').

### Using the beard styler attachment without comb

You can use the beard styler attachment without the comb to contour your beard, moustache, sideburns or neckline to a length of 0.5mm.

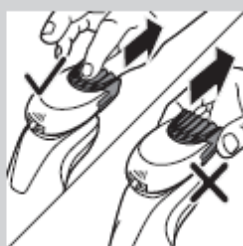

- 1** Pull the comb off the attachment.

*Note: Grab the comb in the centre to pull it off the attachment. Do not pull at the sides of the comb.*

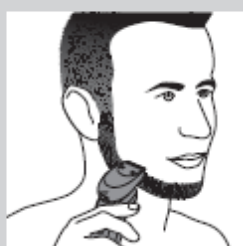

- 2** Switch on the appliance.
- 3** You can now start contouring your beard, moustache, sideburns or neckline by moving the styler downwards with gentle pressure while holding it perpendicular to the skin.
- 4** Clean the attachment after use (see chapter 'Cleaning and maintenance').

### Using the cleansing brush attachment

Use the rotating cleansing brush attachment with your daily cleansing cream. The cleansing brush attachment removes oil and dirt, contributing to a healthy and oil-free skin.



- 1** Insert the lug of the attachment into the slot in the top of the appliance. Then press down the attachment to attach it to the appliance ('click').



- 2** Moisten the attachment with water. Do not use the appliance with a dry brush head, as this can irritate the skin.

*Tip: Use the attachment before shaving for easier shaving and a more hygienic shaving result.*



- 3** Moisten your face with water and apply a cleanser to your face.

- 4** Place the attachment on your right cheek.

- 5** Switch on the appliance.



- 6** Gently move the attachment across your skin from the nose towards the ear. Do not push the attachment too hard onto the skin to make sure the treatment remains comfortable.



- 7** After approx. 20 seconds you can move the appliance to your left cheek and start cleansing this part of your face.

Caution: Do not clean the sensitive area around your eyes.





- 8** After approx. 20 seconds you can move the attachment to your forehead and start cleansing this part of your face. Gently move the brush head from left to right.

*Note: We advise you to not overdo the cleansing and to not cleanse any zone longer than 20 seconds.*



- 9** After the treatment, rinse and dry your face. Your face is now ready for the next step of your daily skincare routine.
- 10** Clean the attachment after use (see chapter 'Cleaning and maintenance').

### Cleaning and maintenance

*Note: The accessories supplied may vary for different products. The box shows the accessories that have been supplied with your appliance.*

#### Cleaning the shaver in the SmartClean system (specific types only)



Do not tilt the SmartClean system to prevent leakage.

*Note: Hold the SmartClean system while you prepare it for use.*

*Note: If you clean the shaver in the SmartClean system once a week, the SmartClean cartridge will last approximately three months.*

#### Preparing the SmartClean system for use

- 1** Put the small plug in the back of the SmartClean system.

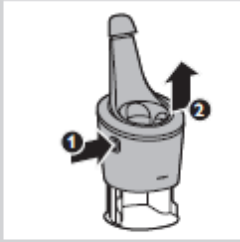

**2** Put the adapter in the wall socket.

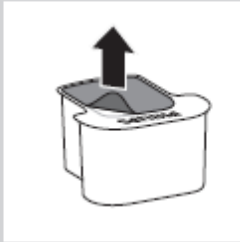

**3** Press the button on the side of the SmartClean system and lift the top part of the SmartClean system.



**4** Pull the seal off the cleaning cartridge.

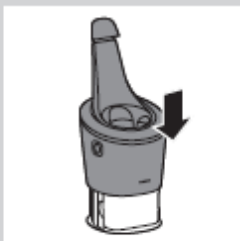

**5** Place the cleaning cartridge in the SmartClean system.



**6** Push the top part of the SmartClean system back down ('click').

### Using the SmartClean system

Always make sure to shake excess water off the shaver before you place it in the SmartClean system.

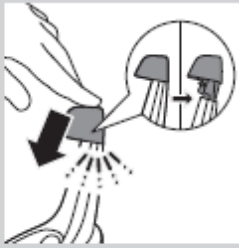

- 1** Press down the top cap to be able to place the shaver in the holder ('click').

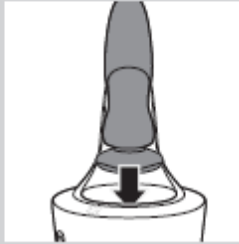

- 2** Hold the shaver upside down above the holder. Make sure the front of the shaver points towards the SmartClean system.

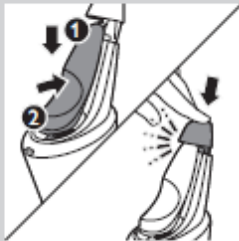

- 3** Place the shaver in the holder, tilt the shaver backwards and press down the top cap to connect the shaver ('click').
  - The battery symbol flashes slowly to indicate that the shaver is charging.

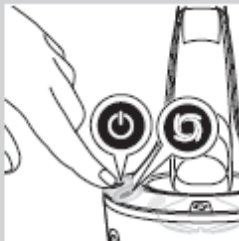

- 4** Press the on/off button on the SmartClean system to start the cleaning program.
  - During the cleaning program (which takes approx. 10 minutes), the cleaning symbol flashes.



- When the cleaning program has been completed, the ready symbol lights up continuously.
- The battery symbol lights up continuously to indicate that the shaver is fully charged. This takes approx. 1 hour.

*Note: If you press the on/off button of the SmartClean system during the cleaning program, the program aborts. In this case, the cleaning symbol stops flashing.*

*Note: If you remove the adapter from the wall socket during the cleaning program, the program aborts.*

*Note: 30 minutes after the cleaning program and charging have been completed, the SmartClean switches off automatically.*

- 5** To let the shaver dry, you can leave it in the SmartClean system until your next shave. You can also remove the shaver from the SmartClean system, shake off excess water, open the shaving unit and let the shaver air dry.

### Replacing the cartridge of the SmartClean System

Replace the cleaning cartridge when the replacement symbol flashes orange or when you are no longer satisfied with the cleaning result.

If you clean the shaver in the SmartClean system once a week, the SmartClean cartridge will last approximately three months.

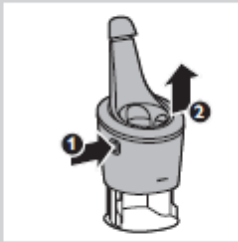

- 1** Press the button on the side of the SmartClean system and lift the top part of the SmartClean system.

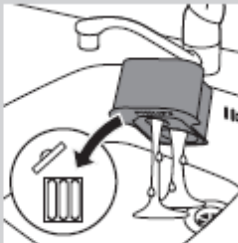

- 2** Take the empty cleaning cartridge from the SmartClean system and pour any remaining cleaning fluid out of the cleaning cartridge. You can simply pour the cleaning fluid down the sink.

- 3** Throw away the empty cleaning cartridge.
- 4** Unpack the new cleaning cartridge and pull the seal off the cartridge.



- 5** Place the new cleaning cartridge in the SmartClean system.



- 6** Push the top part of the SmartClean system back down ('click').

### **Cleaning the shaver under the tap**

---

Clean the shaver after every shave for optimal shaving performance.

Be careful with hot water. Always check if the water is not too hot, to prevent your hands from getting burnt.

Never dry the shaving unit with a towel or tissue, as this may damage the shaving heads.



- 1** Rinse the shaving unit under a warm tap for some time.

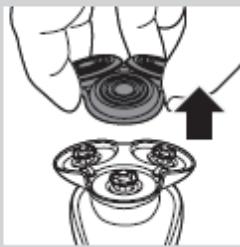

- 2** Pull the shaving head holder off the bottom part of the shaving unit.



**3** Rinse the shaving head holder under a warm tap for 30 seconds.

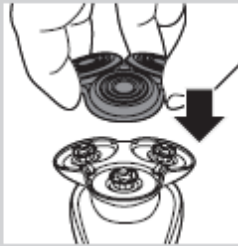

**4** Carefully shake off excess water and let the shaving head holder dry.

**5** Reattach the shaving head holder to the bottom part of the shaving unit ('click').

### Thorough cleaning method

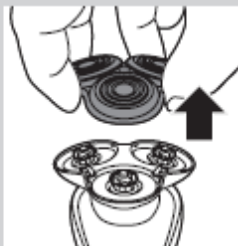

Make sure the appliance is switched off.

**1** Pull the shaving head holder off the bottom part of the shaving unit.

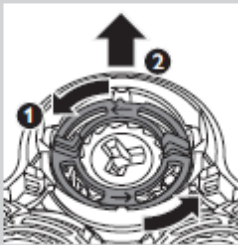

**2** Turn the retaining rings anticlockwise and remove them.



**3** Remove the shaving heads from the shaving head holder. Each shaving head consists of a cutter and guard.

*Note: Do not clean more than one cutter and guard at a time, since they are all matching sets. If you accidentally put a cutter in the wrong shaving guard, it may take several weeks before optimal shaving performance is restored.*

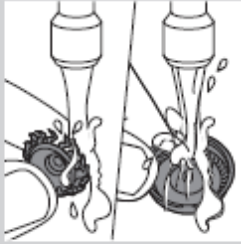

**4** Clean the cutter and guard under the tap.



**5** After cleaning, place the cutter back into the guard.



**6** Put the shaving heads back into the shaving head holder.



*Note: Make sure the notches on both sides of the shaving heads fit exactly onto the projections in the shaving-head holder.*

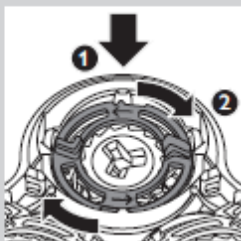

**7** Place the retaining rings back onto the shaving head holder and turn them clockwise.

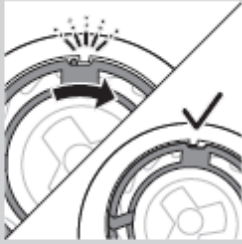

- Each retaining ring has two recesses that fit exactly in the projections of the shaving head holder. Turn the ring clockwise until you hear 'click' and the ring is fixed.



*Note: Hold the shaving head holder in your hand when you reinsert the shaving heads and reattach the retaining rings. Do not place the shaving head holder on a surface when you do this, as this may cause damage.*

- 8** Reattach the shaving head holder to the bottom part of the shaving unit.

### **Cleaning the click-on attachments**

Never dry the trimmer or beard styler attachments with a towel or tissue, as this may damage the trimming teeth.

#### **Cleaning the beard styler attachment**

Clean the beard styler attachment every time you have used it.

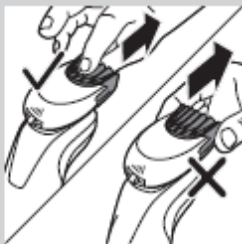

- 1** Pull the comb off the beard styler attachment.

*Note: Grab the comb in the centre to pull it off the attachment. Do not pull at the sides of the comb.*

- 2** Switch on the appliance.

- 3** Rinse the beard styler attachment and the comb separately under a hot tap for some time.

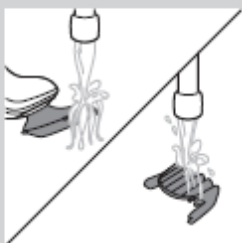

- 4** After cleaning, switch off the appliance.





- 5** Carefully shake off excess water and let the beard styler attachment and comb dry.

*Tip: For optimal trimmer performance, lubricate the trimmer teeth with a drop of sewing machine oil every six months.*

### Cleaning the trimmer attachment

Clean the trimmer attachment every time you have used it.



- 1** Switch on the appliance with the trimmer attachment attached.

- 2** Rinse the trimmer attachment under a hot tap for some time.



- 3** After cleaning, switch off the appliance.

- 4** Carefully shake off excess water and let the trimmer attachment dry.

*Tip: For optimal trimmer performance, lubricate the trimmer teeth with a drop of sewing machine oil every six months.*



### Cleaning the cleansing brush attachment

Clean the cleansing brush attachment every time you have used it.

- 1** Make sure the appliance is switched off.

- 2** Detach the brush head from the brush base.



- 3** Clean both parts thoroughly with warm water and mild soap.



- 4** Dry the cleansing brush attachment with a towel.

### Storage



*Note: The accessories supplied may vary for different products. The box shows the accessories that have been supplied with your appliance.*

*Note: We advise you to let the appliance and its attachments dry before you put the protection caps on the attachments and store the shaver in the pouch.*

- Store the shaver in the pouch supplied.
- Put the protection cap on the cleansing brush attachment to protect it from dirt accumulation.



### Replacement

#### Replacing the cleansing brush head

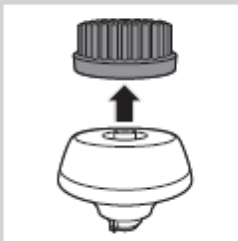

- The cleansing brush head attachment should be replaced every 3 months or earlier if the filaments are deformed or damaged.

## Replacing the shaving heads

For maximum shaving performance, we advise you to replace the shaving heads every two years.

### Replacement reminder

The shaving unit symbol will light up to indicate that the shaving heads need to be replaced. Replace damaged shaving heads immediately. Only replace the shaving heads with original Philips shaving heads as specified in chapter 'Ordering accessories'.

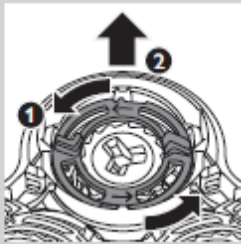
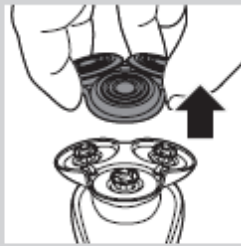

- 1** The shaving unit symbol lights up continuously when you switch off the shaver to indicate that the shaving heads need to be replaced.
- 2** Pull the shaving head holder off the bottom part of the shaving unit.
- 3** Turn the retaining rings anticlockwise and remove them.
- 4** Remove the shaving heads from the shaving head holder and throw them away.



**5** Place new shaving heads in the holder.

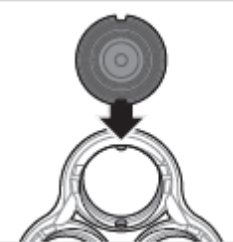

*Note: Make sure the notches on both sides of the shaving heads fit exactly onto the projections in the shaving-head holder.*

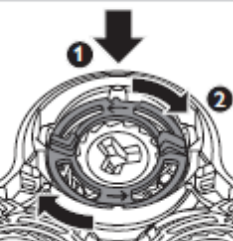

**6** Place the retaining rings back onto the shaving heads and turn them clockwise.

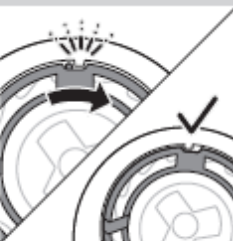

- The retaining ring has two recesses that fit exactly in the projections of the shaving head holder. Turn the ring clockwise until you hear 'click' and the ring is fixed.



*Note: Hold the shaving head holder in your hand when you reinsert the shaving heads and reattach the retaining rings. Do not place the shaving head holder on a surface when you do this, as this may cause damage.*

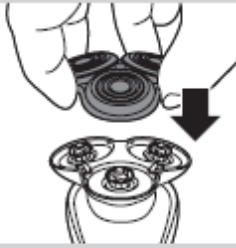

- 7** Reattach the shaving head holder to the bottom part of the shaving unit.

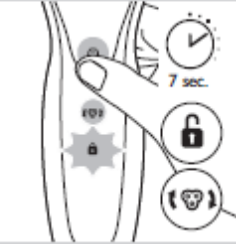

- 8** To reset the replacement reminder, press and hold the on/off button for approx. 7 seconds.

### Ordering accessories

To buy accessories or spare parts, visit **[www.shop.philips.com/service](http://www.shop.philips.com/service)** or go to your Philips dealer. You can also contact the Philips Consumer Care Centre in your country (see the worldwide guarantee leaflet for contact details).

The following parts are available:

- HQ8505 adapter
- SH70 Philips shaving heads
- HQ110 Philips Shaving Head Cleaning Spray
- RQ111 Philips beard styler attachment
- SH575 Philips cleansing brush attachment
- SH560 Philips cleansing brush replacement head
- JC301, JC302, JC303, JC304, JC305 cleaning cartridge

*Note: Availability of the accessories may differ per country.*



### Shaving heads

- We advise you to replace your shaving heads every two year. Always replace the shaving heads with original SH70 Philips shaving heads.

### Recycling



- This symbol means that this product shall not be disposed of with normal household waste (2012/19/EU).



- This symbol means that this product contains a built-in rechargeable battery which shall not be disposed of with normal household waste (2006/66/EC). We strongly advise you to take your product to an official collection point or a Philips service centre to have a professional remove the rechargeable battery.
- Follow your country's rules for the separate collection of electrical and electronic products and rechargeable batteries. Correct disposal helps prevent negative consequences for the environment and human health.

### Removing the rechargeable shaver battery

Only remove the rechargeable battery when you discard the shaver. Make sure the battery is completely empty when you remove it.

Be careful, the battery strips are sharp.

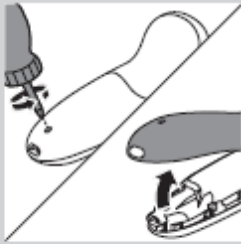

- 1** Remove the screw in the back panel with a screwdriver. Then remove the back panel.

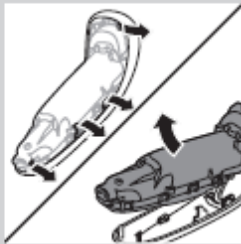

- 2** Bend the hooks aside and remove the power unit.

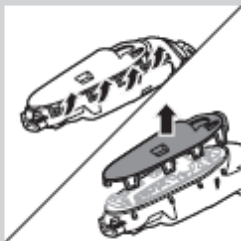

- 3** Break the snap hooks and remove the front panel of the power unit.

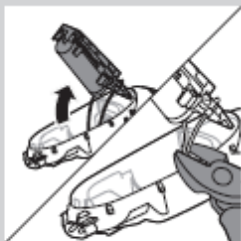

- 4** Take out the battery holder and cut the battery tags with a pair of cutting pliers.

### **Guarantee and support**

If you need information or support, please visit [www.philips.com/support](http://www.philips.com/support) or read the separate worldwide guarantee leaflet.

### **Guarantee restrictions**

The shaving heads (cutters and guards) are not covered by the terms of the international guarantee because they are subject to wear.

## Troubleshooting

This chapter summarises the most common problems you could encounter with the appliance. If you are unable to solve the problem with the information below, visit [www.philips.com/support](http://www.philips.com/support) for a list of frequently asked questions or contact the Consumer Care Centre in your country.

Problem	Possible cause	Solution
The shaver does not shave as well as it used to.	The shaving heads are damaged or worn.	Replace the shaving heads (see chapter 'Replacement').
	Hairs or dirt obstruct the shaving heads.	Clean the shaving heads by following the steps of the thorough cleaning method (see chapter 'Cleaning and maintenance').
The shaver does not work when I press the on/off button.	The shaver is still attached to the mains. For safety reasons, the shaver can only be used without cord.	Disconnect the shaver from the mains and press the on/off button to switch on the shaver (see section 'Unplug for use reminder').
	The rechargeable battery is empty.	Recharge the battery (see chapter 'Charging').
	The travel lock is activated.	Press the on/off button for 3 seconds to deactivate the travel lock.
	The shaving unit is soiled or damaged to such an extent that the motor cannot run.	Clean the shaving heads or replace them (see chapters 'Cleaning and maintenance' and 'Replacement').



Problem	Possible cause	Solution
The shaver is not entirely clean after I clean it in the SmartClean system.	You have not placed the shaver in the SmartClean system properly, so there is no electrical connection between the SmartClean system and the shaver.	Press down the top cap ('click') to ensure a proper connection between the shaver and the SmartClean system.
	The cleaning cartridge is empty. The replacement symbol flashes to indicate you have to replace the cleaning cartridge.	Place a new cleaning cartridge in the SmartClean system (see chapter 'Cleaning and maintenance').
	You have used another cleaning fluid than the original Philips cleaning cartridge.	Only use the original Philips cleaning cartridges.
Water is leaking from the bottom of the shaver.	During cleaning, water may collect between the inner body and the outer shell of the shaver.	This is normal and not dangerous because all electronics are enclosed in a sealed power unit inside the shaver.
The SmartClean system does not work when I press the on/off button.	The SmartClean system is not connected to the mains.	Put the small plug in SmartClean system and put the adapter in the wall socket.

Problem	Possible cause	Solution
The shaver is not fully charged after I charge it in the SmartClean system.	You have not placed the shaver in the SmartClean system properly.	Make sure you press the shaver in the SmartClean system until it locks into place.
I replaced the shaving heads, but the replacement reminder symbol is still showing.	You have not reset the shaver.	Reset the shaver by pressing the on/off button for approx. 7 seconds (see chapter 'Replacement').
A shaving head symbol has suddenly appeared on the display.	This symbol is a replacement reminder.	Replace the shaving heads (see chapter 'Replacement').