

Electric Shaver

User's manual

EN



SENCOR®

SMS 4011BL

SMS 4012GR

SMS 4013RD

SMS 4014TQ

Prior to using this appliance, please read the user's manual thoroughly, even in cases where you have previously familiarised yourself with the operation of similar types of appliances. Only use the appliance in the manner described in this user's manual. Keep this user's manual in a safe place where it can be easily retrieved for future use.

We recommend saving the original shipping cardboard box, packaging material, receipt and warranty card for at least the duration of warranty. In the event of transportation, pack the appliance using the original packaging materials only.

TABLE OF CONTENTS

IMPORTANT SAFETY INSTRUCTIONS	3
BEFORE USING	6
CHARGING	7
CLEANING AND MAINTENANCE	8
REPLACEMENT OF THE SHAVING HEAD	9
TECHNICAL SPECIFICATIONS	10
INSTRUCTIONS AND INFORMATION REGARDING THE DISPOSAL OF USED PACKAGING MATERIALS	11
DISPOSAL OF USED ELECTRICAL AND ELECTRONIC EQUIPMENT	11

IMPORTANT SAFETY INSTRUCTIONS

READ CAREFULLY AND STORE FOR FUTURE USE.

- This appliance may be used by children 8 years of age and older and by persons with physical or mental impairments or by inexperienced persons, if they are properly supervised or have been informed about how to use the appliance in a safe manner and understand the potential dangers. Do not allow children to play with the appliance.
- Cleaning and maintenance that may be performed by the user must not be performed by unsupervised children. Keep this appliance and the power cord out of reach of children that are younger than 8 years of age.
- This electric shaver is intended for shaving facial hair. Do not use it for shaving legs or the armpit or groin areas, or for grooming animal hair.
- This electric shaver is intended for domestic use. Do not use it for commercial purposes.
- Only use the power adapter, USB cable and accessories supplied with the electric shaver.

- Before connecting the adapter to a power socket, make sure the voltage stated on its rating label corresponds to the voltage in your power socket.
- Do not expose the electric shaver or its accessories to the outdoor environment, extreme temperatures, direct sunlight, excessive humidity or excessively dusty environments.
- Do not place it near heaters, open fires or other appliances or equipment that are sources of heat.

**Warning:**

This electric shaver is not designed to be used in the bath or shower, therefore keep it dry.

- Charge and use the electric shaver at a sufficient distance from the bath, wash basin or other containers filled with water.
- This electric shaver is not designed to be washed under the water tap. Do not spray it with water or any other liquid or submerge it in water or any other liquid.

Electric Shaver

SMS 4011BL / SMS 4012GR / SMS 4013RD / SMS 4014TQ

EN

- We do not recommend using the electric shaver on parts of the face where there are open wounds, lacerations, sunburns or blisters.
- When the electric shaver is turned on, keep it at a sufficient distance from hair and eyes.
- Store the electric shaver with the protective cover placed on the shaving foil to prevent its damage.
- Do not place the USB cable near hot places or over sharp objects.
- Do not use the electric shaver, USB cable or power adapter if it is damaged. A damaged USB cable or power adapter must be replaced for a new one of the same type. For all repairs of the appliance, replacement of damaged USB cables or power adapters, please contact an authorised service centre. Do not repair the electric shaver yourself or modify it any way to prevent a dangerous situation from arising. By tampering with the product you risk voiding your legal rights arising from unsatisfactory performance or quality warranty.

BEFORE USING

It will take some time before you get used to your new electric shaver because your skin and facial hair need approximately 2 – 3 weeks to become accustomed to any new shaving method.

Store and recharge the electric shaver at a temperature of 5 – 35 °C.

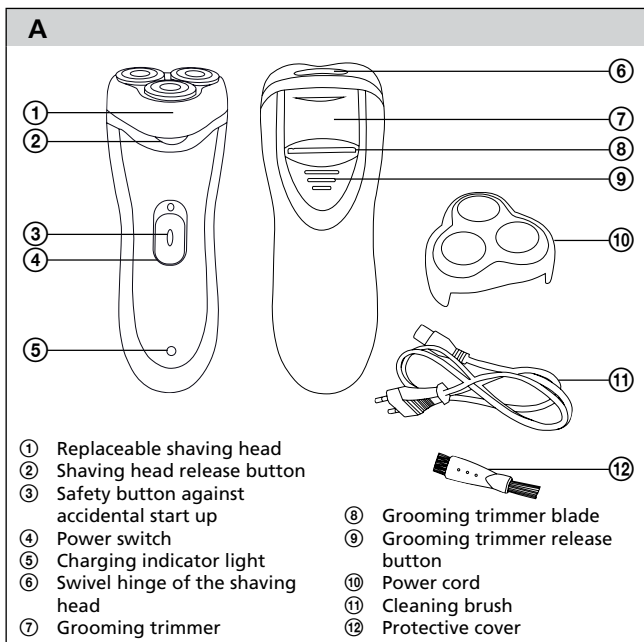
DESCRIPTION OF THE ELECTRIC SHAVER

Electric Shaver

SMS 4011BL / SMS 4012GR / SMS 4013RD / SMS 4014TQ

EN

CHARGING

If you are charging the electric shaver for the first time or after an extended period of no use, allow it to charge continuously for at least 15 hours, e.g. overnight. A standard charge usually takes approx. 8 hours.

1. Prior to charging, make sure that the electric shaver is turned off.
2. Connect the charger cord to the electric shaver and the other end to a power socket – the indicator will be lit red during the charging process.
3. When it is fully charged, you can shave with this electric shaver for approximately 45 minutes.
4. Do not leave it connected to the power socket for longer than 24 hours.

USING THE ELECTRIC SHAVER

B



1. Remove the protective cover A^⑩.
2. Turn on the electric shaver by moving the power switch A^④ upwards while at the same time holding down the safety button A^③.
3. Move the electric shaver quickly over your skin in the opposite direction to the growth of your facial hair. In order to achieve the best results, combine straight and rotating movements. It is not necessary to moisten the skin before shaving or to use a shaving cream or gel.

**Attention:**

This electric shaver is not designed to be washed under a water tap. Do not spray it with water or any other liquid, do not submerge it in water or any other liquid or wash it with any cleaning agents. This applies also to its parts.

**Note:**

It may take your skin two to three weeks to become accustomed to the new way of shaving.

4. After you have finished shaving, turn off the electric shaver by moving the power switch A④ downwards while at the same time holding down the safety button A③.
5. Clean out the electric shaver after every shave (see following chapter) and place the protective cover A⑩ on to it.

Using the grooming trimmer function

1. Slide out the trimmer blade by pushing the trimmer release button downwards.
2. Turn on the electric shaver by moving the power switch upwards while at the same time holding down the safety.
3. When you have finished trimming, turn the electric shaver off and snap in the trimming blade.
4. After every use, clean out the shaver (see following chapter).

CLEANING AND MAINTENANCE

Regular cleaning of the electric shaver after every shave will extend the lifetime of the blades and you will achieve better shaving results.

**Attention:**

This electric shaver must not be washed under the water tap. Do not spray it with water or any other liquid, do not submerge it in water or any other liquid or wash it with any cleaning agents. This applies also to its parts.

1. Turn off the electric shaver.
2. Remove the protective cover A⑩.
3. Press the release button A② and tilt out the shaving head.

Electric Shaver

SMS 4011BL / SMS 4012GR / SMS 4013RD / SMS 4014TQ

EN



Tip:

It is best to clean the shaving head above a wash basin or waste bin, because after each shave, the area under the shaving head is full of facial hair clippings.

4. Use the provided cleaning brush to clean out the shaving head, the area under the head and the trimmer blade.
5. Snap in the trimmer blade and shaving head.

REPLACEMENT OF THE SHAVING HEAD

In order to keep your electric shaver running at its best, we recommend replacing the shaving head depending on the degree of wear.

The shaving head is sold as a complete set under the model name SENCOR SMX 004.

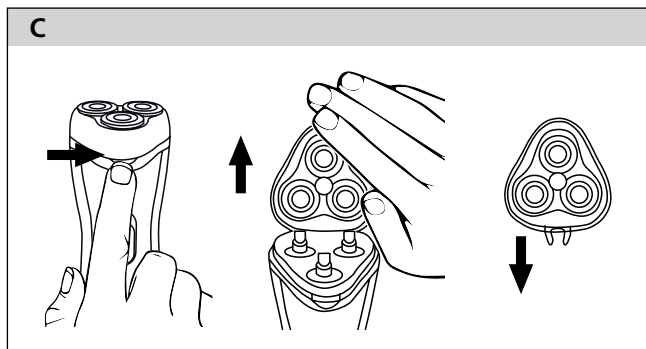

1. Press the shaving head release button.
2. Tilt the shaving head into horizontal position.
3. Pull upwards to remove the shaving head.
4. Insert the new head in reverse sequence until you hear a click.
5. Click in the shaving head.
6. The shaving head is now successfully replaced.

TECHNICAL SPECIFICATIONS

Electric Shaver

Rated voltage	3 V ---
Noise level	73 dB(A)
Dimensions (width \times depth \times height)	5.5 \times 5.3 \times 13.5 cm
Weight	150 g
Rated power	3 W
Rated frequency	50 Hz
Rated voltage	220 – 240 V

The declared noise emission level of the appliance is 73 dB(A), which represents a level A of sound power with respect to a reference sound power of 1 pW.

Explanation of technical terminology

Safety class for electrical shock protection:

Class II – Electrical shock protection is provided by double or heavy-duty insulation.

We reserve the right to change text and technical specifications.

INSTRUCTIONS AND INFORMATION REGARDING THE DISPOSAL OF USED PACKAGING MATERIALS

Dispose of used packaging material at a site designated for waste in your municipality.

DISPOSAL OF USED ELECTRICAL AND ELECTRONIC EQUIPMENT



This symbol on products or original documents means that used electric or electronic products must not be added to ordinary municipal waste. For proper disposal, renewal and recycling hand over these appliances to determined collection points. Alternatively, in some European Union states or other European countries you may return your appliances to the local retailer when buying an equivalent new appliance. Correct disposal of this product helps save valuable natural resources and prevents potential negative effects on the environment and human health, which could result from improper waste disposal. Ask your local authorities or collection facility for more details. In accordance with national regulations penalties may be imposed for the incorrect disposal of this type of waste.

For business entities in European Union states

If you want to dispose of electric or electronic appliances, ask your retailer or supplier for the necessary information.

Disposal in other countries outside the European Union.

This symbol is valid in the European Union. If you wish to dispose of this product, request the necessary information about the correct disposal method from the local council or from your retailer.



This appliance meets all the basic requirements of EU directives related to it.

Electric Shaver

SMS 4011BL / SMS 4012GR / SMS 4013RD / SMS 4014TQ